



2010.1

TRADE PRICELIST SECTION 3: ROLLER PARTS AND TRANSMISSION GEAR



Portico Products

Lath Lane
Smethwick
West Midlands
B66 1EA

telephone: 0121 553 7222
fax: 0121 553 3577
email: sales@porticoproducts.com
website: www.porticoproducts.com

NOTES:

- All prices are nett GBP ex works plus carriage* plus VAT
- All orders are subject to our standard terms & conditions as laid out in our TRADE PRICELIST SECTION 10 and available on request
- If you can't see the item you want, please call our sales department - as well as stocked items we have access to a huge range of products bought in to order
- Quantity discounts refer to the Unit of Sale for that item - eg: the 5+ price for an item priced in 1000s means that to buy at that price you would need to buy 5000+ pcs, the 10+ price for an item priced per metre means that to buy at that price you would need to buy 10+ mtrs
- Quantity discounts are awarded on an order by order basis, however some may be available for call-off orders - please ask our sales team for details

*carriage and packing as laid out in our TRADE PRICELIST SECTION 10

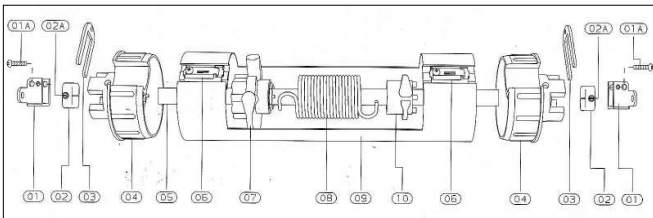

BLOCKS (PLAIN BORE)

| | | gauges | 1+ | 20+ | 50+ |
|--------|-----------------------------|--------|------|------|---------|
| 4PLIN | 4" Plastic 5/8" bore INNER | 16 | 0.57 | 0.56 | 0.53/ea |
| 4PLOUT | 4" Plastic 5/8" bore OUTER | 16 | 0.57 | 0.56 | 0.53/ea |
| 4AL5/8 | 4" Cast Aluminium 5/8" bore | 16 | 1.97 | 1.86 | 1.81/ea |
| 4AL3/4 | 4" Cast Aluminium 3/4" bore | 16 | 1.97 | 1.86 | 1.81/ea |
| 4MI5/8 | 4" Cast MI 5/8" bore | 16 | 2.97 | 2.75 | 2.49/ea |
| 4MI3/4 | 4" Cast MI 3/4" bore | 16 | 2.97 | 2.75 | 2.49/ea |



BLOCKS (with OILITE BUSH)

| | | gauges | 1+ | 20+ | 50+ |
|---------|----------------------------------|--------|-------|-------|----------|
| 4MIB5/8 | 4" Cast MI 5/8" bush | 16 | 6.05 | 5.83 | 5.61/ea |
| 4MIB3/4 | 4" Cast MI 3/4" bush | 16 | 5.21 | 4.99 | 4.69/ea |
| 5PS | 5" Pressed Steel 1" bush | 10 | | 5.67 | 5.40 |
| | 5.33/ea | | | | |
| 5MI | 5" Cast MI 1" bush | 10 | 9.99 | 9.49 | 8.99/ea |
| 5MIN | 5" Cast MI 1" bush (INNER BLOCK) | 10 | 6.99 | 6.85 | 6.76/ea |
| 5S | 5" Steel Disc 1" bush | 10 | 7.85 | 7.66 | 7.25/ea |
| 512MI | 5.5" Cast MI 1" bush | 10 | 13.52 | 13.23 | 12.93/ea |
| 5.5S | 5.5" Steel Disc 1" bush | 10 | 8.24 | 8.04 | 7.57/ea |



SPRING ANCHORS

| | | | 1+ | 20+ | 50+ |
|------------|--------------------------|--|------|------|---------|
| ANCHOR5/8 | Cast MI to suit 5/8" rod | | 1.64 | 1.49 | 1.27/ea |
| ANCHOR3/4 | Cast MI to suit 3/4" rod | | 2.38 | 2.27 | 2.19/ea |
| ANCHOR1 | Cast MI to suit 1" rod | | 3.86 | 3.68 | 3.55/ea |
| ANCHOR1-HD | Cast MI to suit 1" rod | | 2.24 | 2.16 | 2.08/ea |



CUPS

| | | | 2+ | 20+ | 50+ |
|---------|--|------|------|---------|-----|
| CUP7/16 | Cast MI for 5/8" rod milled to 7/16" flats | 0.75 | 0.69 | 0.60/ea | |
| CUP1/2 | Cast MI for 3/4" rod milled to 1/2" flats | 0.85 | 0.79 | 0.70/ea | |
| CUP3/4 | Cast MI for 1" rod milled to 3/4" flats | 1.59 | 1.49 | 1.39/ea | |



RODS

| | | LENGTH | 1+ | 5+ | 10+ |
|---------|-------------------------|--------|------|------|----------|
| ROD5/8S | Steel Rod 5/8" diameter | 3 | 2.55 | 2.45 | 2.35/mtr |
| ROD3/4S | Steel Rod 3/4" diameter | 3 | 3.64 | 3.51 | 3.45/mtr |
| ROD1S | Steel Rod 1" diameter | 3 | 6.43 | 6.27 | 6.12/mtr |



TUBES

| | | LENGTH | 1+ | 5+ | 10+ |
|---------|-----------------------|--------|-------|-------|-----------|
| TUBE416 | Steel Tube 4" x 16swg | 6 | 7.50 | 7.32 | 7.19/mtr |
| TUBE410 | Steel Tube 4" x 10swg | 6 | 13.26 | 12.65 | 12.34/mtr |

PLEASE NOTE OTHER TUBE SIZES AVAILABLE TO ORDER

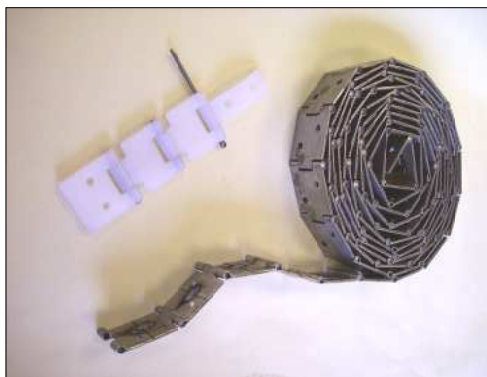

ENDPLATES

| | | 1+ | 10+ | 20+ |
|------------|-----------------|-------|------|---------|
| PLATE10 | 10" x 10" x 3mm | 2.26 | 2.20 | 2.06/ea |
| PLATE12 | 12" x 12" x 3mm | 3.95 | 3.85 | 3.58/ea |
| PLATE12/6 | 12" x 12" x 6mm | 5.41 | 5.28 | 5.00/ea |
| PLATE14/6 | 14" x 14" x 6mm | 6.11 | 5.84 | 5.70/ea |
| PLATE15/6 | 15" x 15" x 6mm | 7.89 | 7.70 | 7.41/ea |
| PLATE15/20 | 20" x 15" x 6mm | 10.15 | 9.90 | 9.31/ea |

LATH / BARREL ATTACHMENTS



| | | LENGTH | 1+ | 10+ | 20+ |
|-------|----------------------|--------|------|------|---------|
| HINGE | Continuous Top Hinge | 5 | 7.65 | 7.37 | 7.09/yd |

| | | 1+ | 20+ | 50+ |
|---------|---|------|------|---------|
| HINGEPL | Plastic Hinge—3 seg (c/w barrel clip & pin) | 0.67 | 0.65 | 0.61/ea |

GEARS (STEEL)

| | | 1+ | 5+ | 10+ |
|---------|-------------------------------------|-------|-------|----------|
| GEAR66 | 66T x 6DP c/w 1" Oilite Bush | 51.85 | 49.96 | 48.04/ea |
| GEAR48 | 48T x 6DP c/w 1" Oilite Bush | 31.45 | 30.30 | 29.14/ea |
| GEAR18B | 18T x 6DP c/w 1" Oilite Bush | 22.54 | 21.99 | 21.69/ea |
| GEAR12B | 12T x 6DP c/w 1" Oilite Bush | 15.50 | 15.05 | 14.75/ea |
| GEAR18K | 18T x 6DP c/w 1" bore & 1/4" keyway | 22.54 | 21.99 | 21.69/ea |
| GEAR12K | 12T x 6DP c/w 1" bore & 1/4" keyway | 15.50 | 15.05 | 14.75/ea |

NOTE WE ALSO STOCK PLATEWHEELS (IE CHAIN SPROCKETS)

GEARS (PLASTIC)

| | | 1+ | 5+ | 10+ |
|-----------|------------------------------------|-------|-------|----------|
| PLGEAR | 48T x 5DP c/w 25mm bore | 13.60 | 13.10 | 12.60/ea |
| PLPINION | 12T x 5DP c/w 1" bore + mtg flange | 10.10 | 9.85 | 9.40/ea |
| GEAR48/12 | 48:12T x 5DP compound c/w 1" bore | 36.21 | 34.89 | 33.55/ea |



CHAINWHEELS (ALUMINIUM)

| | | 1+ | 5+ | 10+ |
|---------|----------------------|-------|-------|----------|
| CW7AL | 7" c/w 1" plain bore | 12.21 | 11.76 | 11.31/ea |
| CW9AL | 9" c/w 1" plain bore | 15.10 | 14.55 | 13.99/ea |
| CW12AL | c/w 1" plain bore | 33.25 | 32.04 | 30.81/ea |
| CW7ALU | 7" Unmachined | 9.66 | 9.30 | 8.95/ea |
| CW9ALU | 9" Unmachined | 12.41 | 11.96 | 11.50/ea |
| CW12ALU | 12" Unmachined | 30.57 | 29.45 | 28.32/ea |

CHAINWHEELS with PINIONS

| | | 1+ | 5+ | 10+ |
|---|--|----|----|-----|
| ALUMINIUM CHAINWHEELS c/w STEEL PINION GEARS:~ | | | | |

| | | | | |
|--------|---------------------------------------|-------|-------|----------|
| CWP7AL | 7" c/w 18T pinion with 1" Oilite Bush | 44.22 | 42.60 | 40.97/ea |
| CWP9AL | 9" c/w 18T pinion with 1" Oilite Bush | 31.78 | 31.00 | 30.00/ea |

PLASTIC CHAINWHEEL c/w PLASTIC PINION:~

| | | | | |
|--------|------------------------------------|-------|-------|----------|
| CWP7PL | 9" c/w 12T 5DP pinion with 1" bore | 13.33 | 13.00 | 12.00/ea |
|--------|------------------------------------|-------|-------|----------|



CHAIN & MISCELLANEOUS PARTS

| | | 1+ | 50+ | 100+ |
|------------------|--|-------------|-------------|-----------------|
| CHAIN | Hand Chain - Zinc plated | 1.87 | 1.80 | 1.73/mtr |
| CHGUIDE7 | Chain Guide to suit 7" chainwheels | 4.76 | 4.59 | 4.41/ea |
| CHGUIDE9 | Chain Guide to suit 9" chainwheels | 4.76 | 4.59 | 4.41/ea |
| CHGUIDE12 | Chain Guide to suit 12" chainwheels | 4.76 | 4.59 | 4.41/ea |
| CHBOXST | Chain Locking Bracket ('Box') | 0.99 | 0.92 | 0.85/ea |
| PAD50 | 50mm Padlock for CHBOXST | 9.13 | 8.80 | 8.46/ea |
| STUB | 1" Stub shaft for CWP7PL | 4.86 | 4.74 | 4.53/ea |
| STUB2 | 1" Stub shaft for CWP7AL, CWP9AL, and CWP12AL | 5.38 | 5.25 | 4.81/ea |
| BEARHOUSE | Self-Aligning Bearing 1" | 5.36 | 5.16 | 4.96/ea |

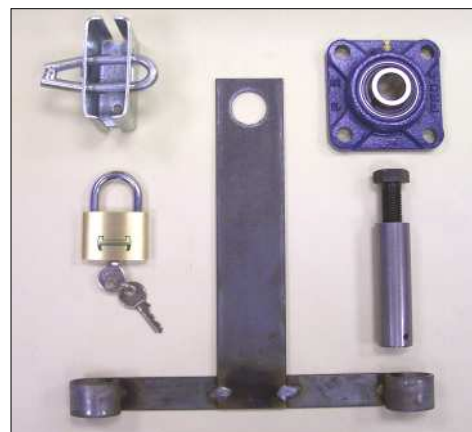

HAND CHAIN DRIVES - SETS OF PARTS

All sets include for:

- 2 Endplates,
- 2 Cups,
- 1 Main Gear,
- 1 Chainwheel/pinion (inboard),
- 1 Chain Guide,
- 10mtrs Hand Chain (8mtrs on CHSETPL & CHSETAL7S),
- 1 Stub shaft,
- 1 Chain Locking Bracket,
- 1 Padlock.

Double Reduction sets also include for:

- A larger drive End Plate
- A compound gear & shaft (unassembled)
- 2 Self-Aligning Bearing Blocks

Please note that we do NOT include fixing angles.

Set prices are NOT pre-drilled - please allow an extra 25.00 if you require this.

| | | 1+ |
|------------------|--|------------------|
| CHSETPL | Single Reduction, Plastic Gearing, 12" x 6mm Endplates | 73.09/ea |
| CHSETAL7S | Single Reduction, Steel 48T Main Gear, 7" Chainwheel, 12" x 6mm Endplates | 120.40/ea |
| CHSETAL9S | Single Reduction, Steel 66T Main Gear, 9" Chainwheel, 15" x 6mm Endplates | 136.90/ea |
| CHSETDRPL | Double Reduction, Plastic Gearing | 133.30/ea |
| CHSETDRAL | Double Reduction, Steel Gearing | 214.51/ea |

